

Fords.

SALES | LETTINGS | NEW HOMES



Flat 11 Victoria House 28-32 Desborough Street, High Wycombe, HP11 2NF

An impressive one-bedroom apartment located in the centre of High Wycombe, offering modern open-plan living. The property boasts a high-specification fitted kitchen with integrated appliances, a generous double bedroom, and a beautifully finished contemporary bathroom.

- **Modern One Double Bedroom Apartment**
- **Close to Town Centre**
- **Residents Parking Available**
- **Bright & Airy Apartment**
- **Modern Kitchen with Appliances**
- **Stylish Family Bathroom**
- **Available Immediately**
- **Quiet Location**

£1,250 Per month

Victoria House

Approx. Gross Internal Area 391 Sq Ft - 36.33 Sq M

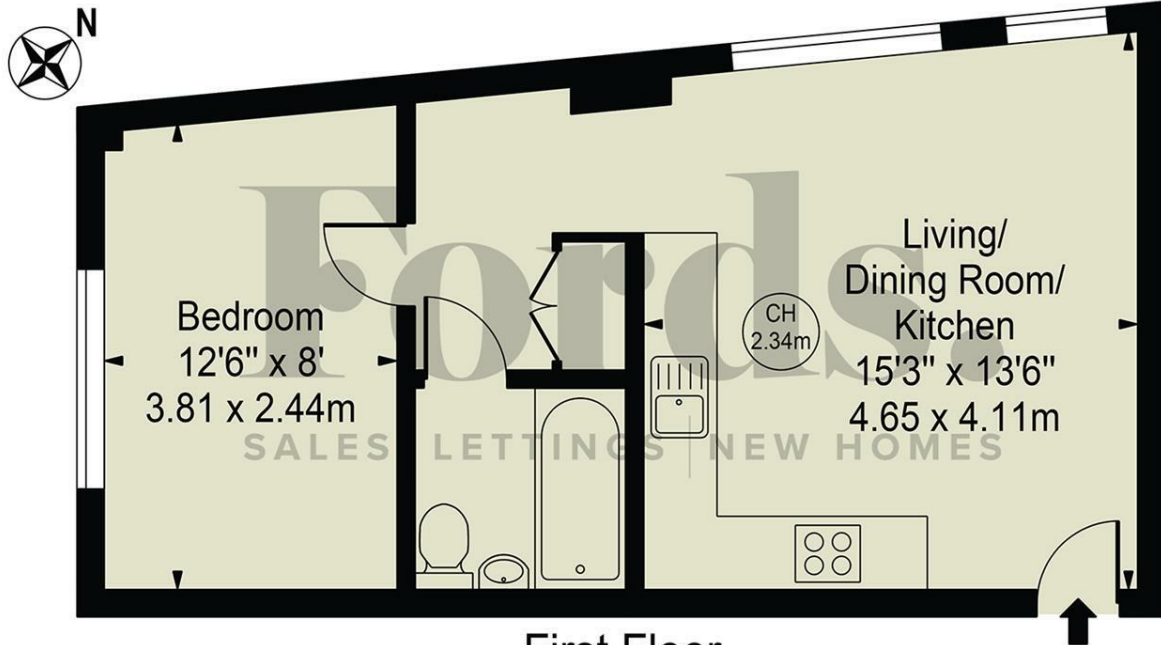

First Floor

For Illustration Purposes Only - Not To Scale

This floor plan should be used as a general outline for guidance only and does not constitute in whole or in part an offer or contract. Any intending purchaser or lessee should satisfy themselves by inspection, searches, enquiries and full survey as to the correctness of each statement. Any areas, measurements or distances quoted are approximate and should not be used to value a property or be the basis of any sale or let. Copyright Morriarti Photography & Design LTD

Energy Efficiency Rating		
	Current	Potential
Very energy efficient - lower running costs		
(92 plus) A		
(81-91) B		
(69-80) C		
(55-68) D		
(39-54) E		
(21-38) F		
(1-20) G		
Not energy efficient - higher running costs		
	78	
England & Wales	EU Directive 2002/91/EC	

Environmental Impact (CO ₂) Rating		
	Current	Potential
Very environmentally friendly - lower CO ₂ emissions		
(92 plus) A		
(81-91) B		
(69-80) C		
(55-68) D		
(39-54) E		
(21-38) F		
(1-20) G		
Not environmentally friendly - higher CO ₂ emissions		
England & Wales	EU Directive 2002/91/EC	



18 Crendon Street, High Wycombe, HP13 6LS

Tel: 01494 840 600 Email: sales@fordandpartners.com www.fordandpartners.com